



#### **GAGGIONE SAS Headquarter**

3, Rue de la Rolland  
01460 Montréal la Cluse  
France

☎ +33 4 74 76 12 66

@ contact@gaggione.com

🌐 www.optic-gaggione.com

#### **Sales Team in GAGGIONE**

Sandrine Mancuso  
France, UK, Italy, Spain

@ s.mancuso@gaggione.com

☎ +33 787 87 84 72

Antoine Le Cordier  
France, Scandinavia,  
Eastern and Northern Europe

@ a.lecordier@gaggione.com

☎ +33 607 37 20 28

Laurent Barel  
Sales & Marketing Director

@ l.barel@gaggione.com

☎ +33 612 04 41 30

#### **International Sales Offices**

GAGGIONE Americas  
Michael Pietro  
12833 Surrey Ct.  
Palos Park, IL  
60464

@ m.pietro@gaggione.com

☎ +1 224 392 0087

GAGGIONE Asia  
Zhen Xu  
Unit 1808, No. 8, Kuaiji Road,  
Jintiandi International building,  
Huangpu District,  
Shanghai, 200021, China

@ z.xu@gaggione.com

☎ +86 136 5189 6981

GAGGIONE Canada  
Stephane Saindon  
744 36th Avenue  
Montreal, Quebec  
H8T3L2

@ s.saindon@gaggione.com

☎ +1 514 928 2179

GAGGIONE DACH  
Angelika Aigner  
Kreuzstrasse 7  
83355 Grabenstätt  
Germany

@ a.aigner@gaggione.com

☎ +49 8661 983 44 77

# GAGGIONE

SHAPING YOUR LIGHT



67 mm  
Silicone collimators  
LLC66

# LLC66

GAGGIONE developed six references to match market requirements on beam angle options: LLC66N7 Narrow beam, LLC66M7 Medium beam, LLC66W7 Wide beam, LLC66L7 Large beam, LLC66V7 Very large beam and LLC66Z7 Zoomable, based on the same patented technology.



10° FWHM

**LLC66N7**  
Narrow Version



20° FWHM

**LLC66M7**  
Medium Version



30° FWHM

**LLC66W7**  
Wide Version

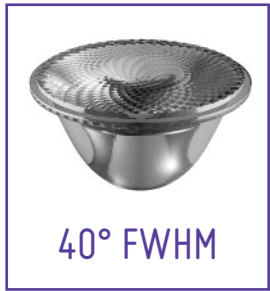

40° FWHM

**LLC66L7**  
Large Version



50° FWHM

**LLC66V7**  
Very Large Version



10°-30° FWHM

**LLC66Z7**  
Zoom version

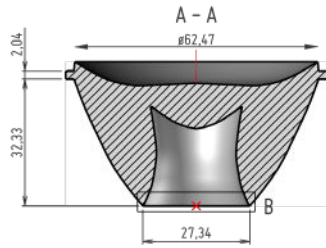
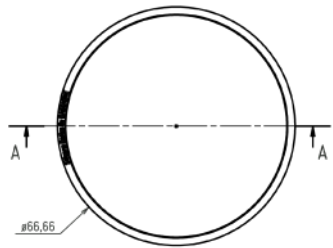

The **LLC66** product range uses the market acclaimed negative draft angle technology to provide a beam without halo nor straylight.

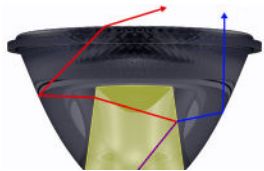

Conventional input shape miss-collects some of the light rays creating halo.

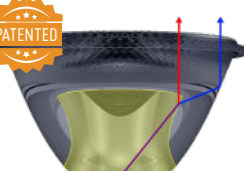

Negative draft angle input shape eliminates straylight with a better light control.

# Compatibility Matrix

	CITIZEN	CITIZEN	CREE	CREE	CREE
<b>LLC66N7</b>	CLU701	CLU711	CXB1310	CXB1520	XHP70
FWHM (°)	9,7	13,7	9,9	13,4	12,0
FWTM (°)	16,9	22,8	16,4	24,0	20,1
Efficacy (cd/lm)	26,2	14,0	28,4	13,2	18,3

	CITIZEN	CITIZEN	CREE	CREE	CREE
<b>LLC66M7</b>	CLU701	CLU711	CXA1310	CXB1520	XHP70
FWHM (°)	21,3	19,9	21,4	20,6	20,1
FWTM (°)	34,0	36,1	33,8	37,4	34,7
Efficacy (cd/lm)	6,2	6,0	6,7	5,4	6,4

	CITIZEN	CITIZEN	CREE	CREE	CREE
<b>LLC66W7</b>	CLU701	CLU711	CXB1310	CXB1520	XHP70
FWHM (°)	31,9	30,8	32,1	30,7	30,2
FWTM (°)	52,7	53,0	51,9	53,9	52,0
Efficacy (cd/lm)	2,4	2,4	2,6	2,3	2,6

	CITIZEN	CREE	XICATO	OSRAM	BRIDGELUX
<b>LLC66L7</b> (LES>13mm)	CLU731	CXA1830	XTM19	SOLERIQ S13	VER013
FWHM (°)	39,1	37,7	35,1	40,7	41,1
FWTM (°)	60,5	59,4	60,0	61,6	63,5
Efficacy (cd/lm)	1,7	1,8	1,9	1,7	1,6

	CITIZEN	CITIZEN	CREE	CREE	CREE
<b>LLC66V7</b> (LES>13mm)	CLU731	CXA1830	XTM19	SOLERIQ S13	VER013
FWHM (°)	54,3	54,9	50,7	55,7	53,5
FWTM (°)	80,9	82,1	79,6	81,7	80,1
Efficacy (cd/lm)	0,9	0,9	1,0	0,9	0,9

	CITIZEN	CITIZEN	CREE	CREE	NICHIA
<b>LLC66Z7</b> (LES< 9mm)	CLU701	CLU711	CXB1310	CXB1520	NVNWS007Z_V1
FWHM (°)	10,0-21,2	14,4-18,9	10,2-21,2	14,0-17,4	10,2-22,5
FWTM (°)	17,8-44,6	22,8-45,5	17,8-44,2	22,6-42,4	17,7-44,5
Efficacy (cd/lm)	24,8-4,1	16,0-4,7	24,4-4,2	13,3-4,7	24,7-4,1

For full compatibility matrix please refer to our website [www.optic-gaggione.com](http://www.optic-gaggione.com)