

# STANDARD RANGE

45 mm PC&PMMA collimator — VEGA

Last update : 03.2023

# VEGA: presentation

Following the success of the LLC59 in PMMA, we launch the VEGA, the COB-oriented version. Many beam sizes are available in PC and PMMA to fit your needs.

## 8 references



**VEGA45U**

Ultra narrow beam



**VEGA45UF**

Ultra narrow beam  
Frosted version



**VEGA45N**

Narrow beam



**VEGA45C**

Color beam



**VEGA45M**

Medium beam



**VEGA45W**

Wide beam



**VEGA45V**

Very large beam  
COMING SOON



**VEGA45E**

Elliptical beam



# VEGA: LED specifications

LES size: Full compatibility : 0 to 6 mm COB / Partial compatibility : 6 to 9 mm

Type of LED: Static white COB, Tunable White COB, RGBW sources, Dim to warm COB

Type of LED	VEGA45U	VEGA45UF	VEGA45N	VEGA45C	VEGA45M	VEGA45W	VEGA45V	VEGA45E
Static White	✓	✓	✓	✓	✓	✓	✓	✓
Tunable White	✗	✗	✗	✓	✓	✓	✓	✓
RGBW	✗	✗	✗	✓	✓	✓	✓	✓
Dim to warm	✗	✗	✗	✓	✓	✓	✓	✓

# VEGA: applications



# VEGA: 2D drawing

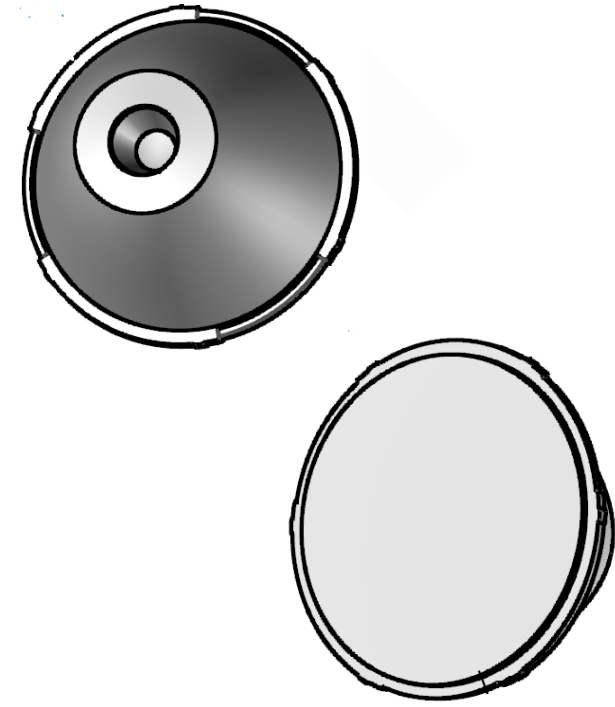
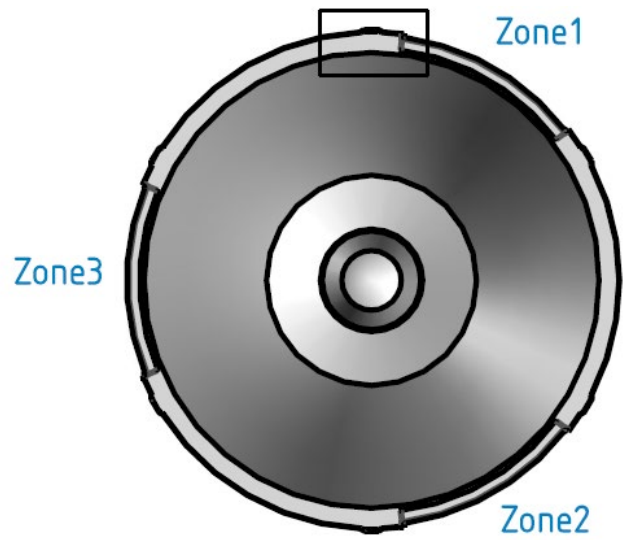
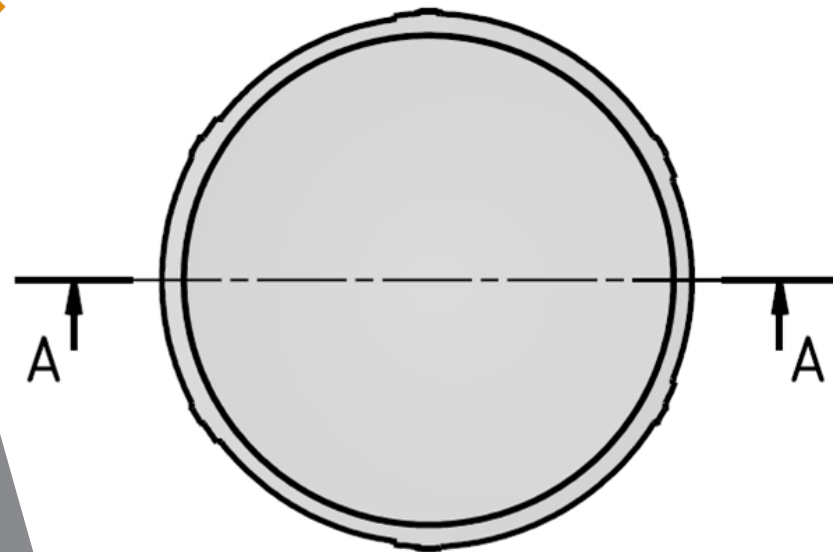
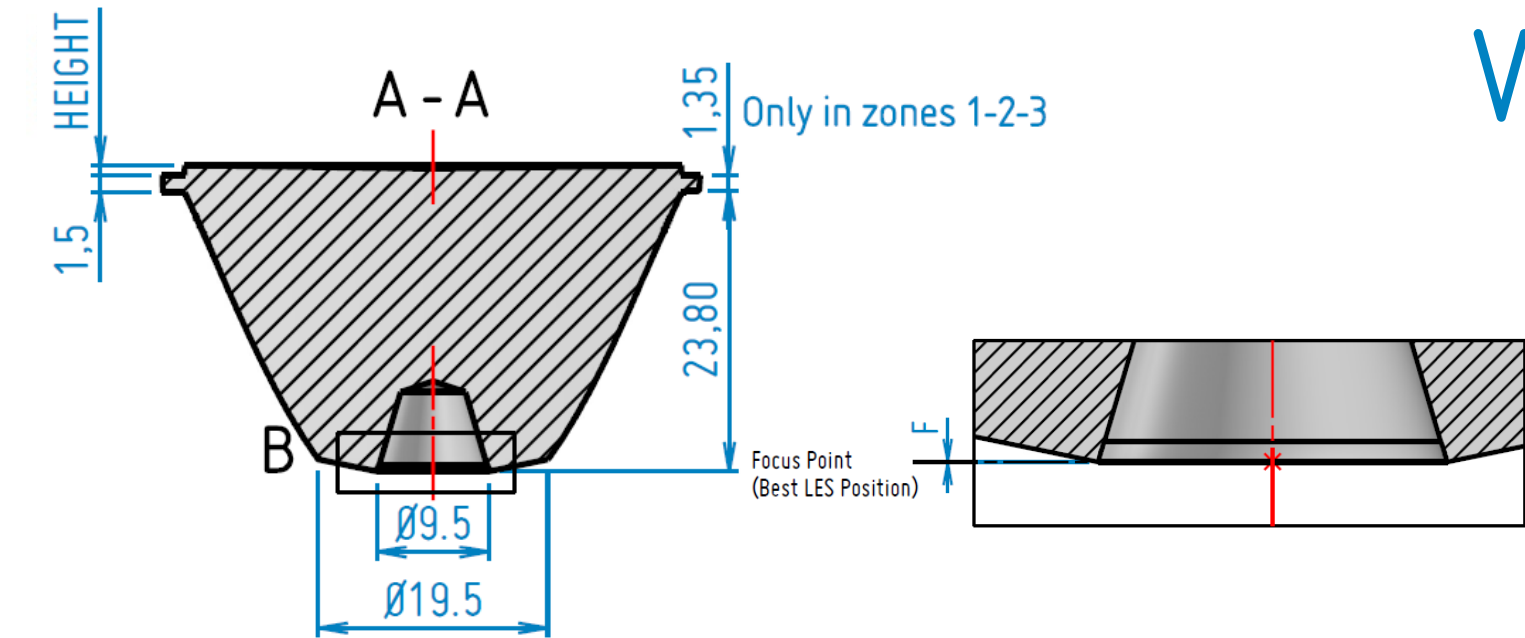

For missing elements, please refer to the 2D plan.  
Without holder, all dimensions are in millimeters.  
General tolerance +/- 0.1mm (standard NF T 58-000 cat. 4, reduced class).

# VEGA45U: Ultra narrow beam



## Compatibility matrix

	CITIZEN	CREE	CREE	LUMINUS
VEGA45U	CLU7S3	CXB1310	CXB1520	CXM_3
FWHM (°)	8,6	12,7	17,9	8,1
FWTM (°)	14,7	21,8	30,8	13,4
Efficacy (cd/lm)	35,2	14,6	6,1	40,5

[Visit the product page of the PMMA version](#)

[Visit the product page the PC version](#)

## Polar Candela Distribution

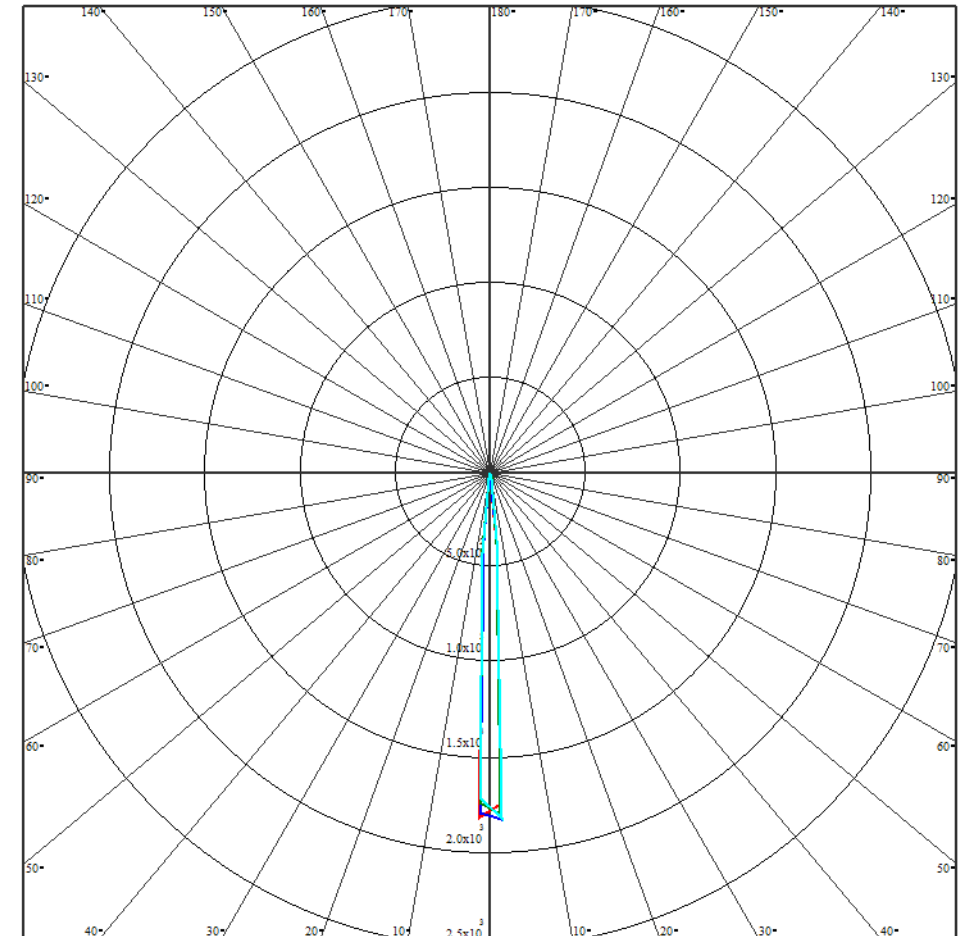

LED: CLU7L3

# VEGA45UF: Ultra narrow beam



## Compatibility matrix

	CITIZEN	CREE	CREE	LUMINUS
VEGA45UF	CLU7S3	CXB1310	CXB1520	CXM_3
FWHM (°)	8,9	13,1	18,4	8,5
FWTM (°)	16,2	23	31,7	16
Efficacy (cd/lm)	28	12,7	5,4	27,4

[Visit the product page of the PMMA version](#)

[Visit the product page the PC version](#)

## Polar Candela Distribution

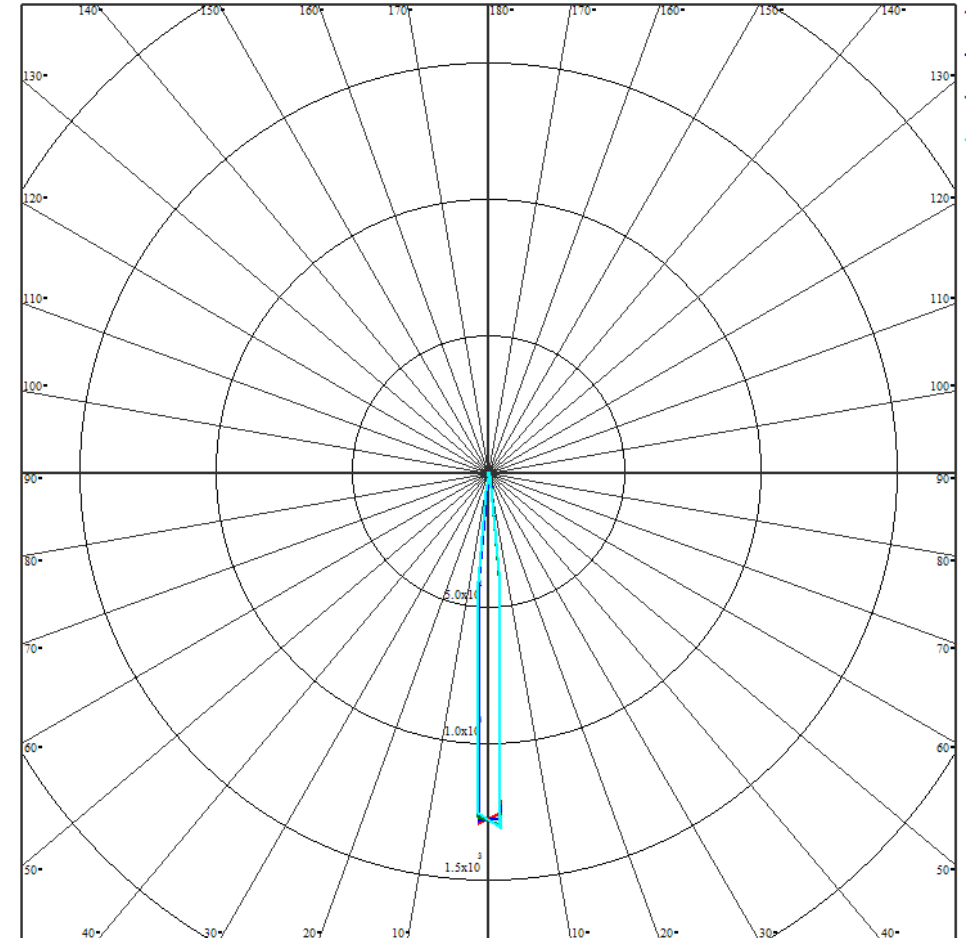

# VEGA45N: Narrow beam



## Polar Candela Distribution

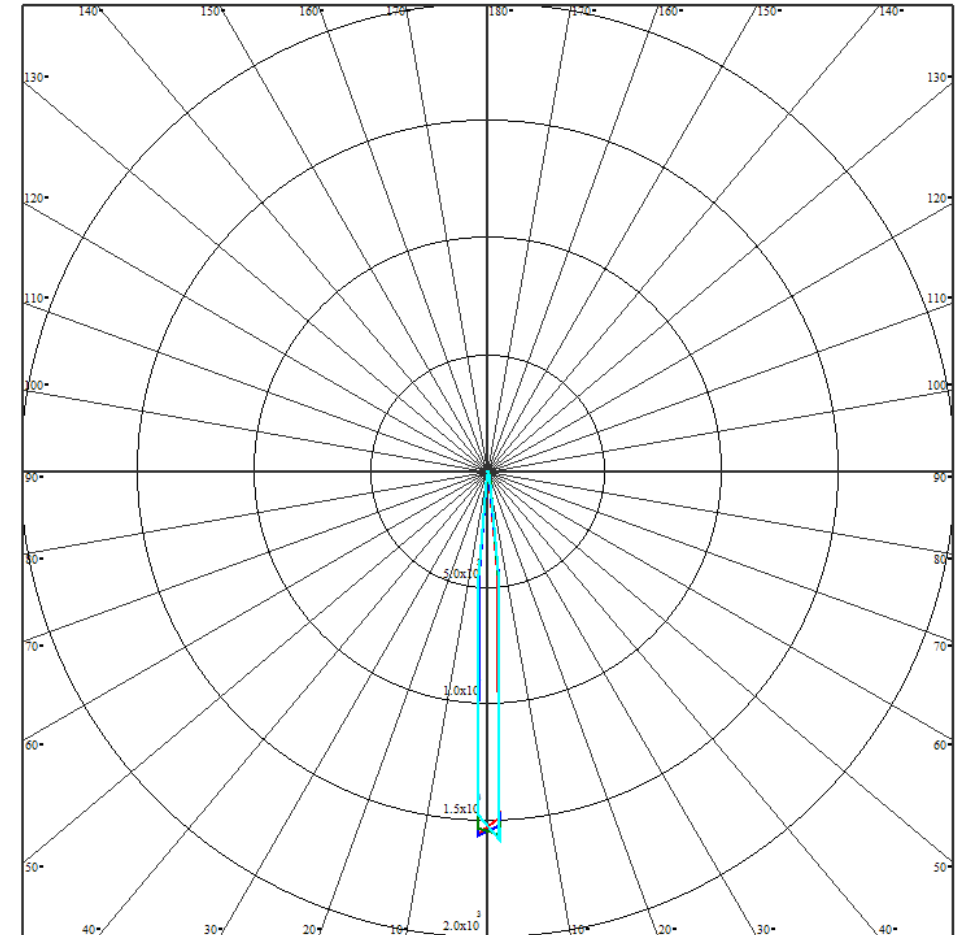

## Compatibility matrix

	CITIZEN	CREE	CREE	LUMINUS
VEGA45N	CLU7S3	CXB1310	CXB1520	CXM_3
FWHM (°)	8,3	12,5	17,5	8,2
FWTM (°)	15,6	22,3	31,4	15,6
Efficacy (cd/lm)	34,3	14,4	6,1	31,9

[Visit the product page of the PMMA version](#)

[Visit the product page the PC version](#)

LED: CLU7L3



# VEGA45C: Color beam



## Compatibility matrix

	CITIZEN	CREE	CREE	BRIDGELUX
VEGA45C	CLU7S3	CXB1310	CXB1520	VESTA_6_TW
FWHM (°)	11,1	13,8	17,9	14,6
FWTM (°)	20,9	26,6	34,6	27,6
Efficacy (cd/lm)	19,2	11,1	5,4	10,4

[Visit the product page of the PMMA version](#)

[Visit the product page the PC version](#)

## Polar Candela Distribution

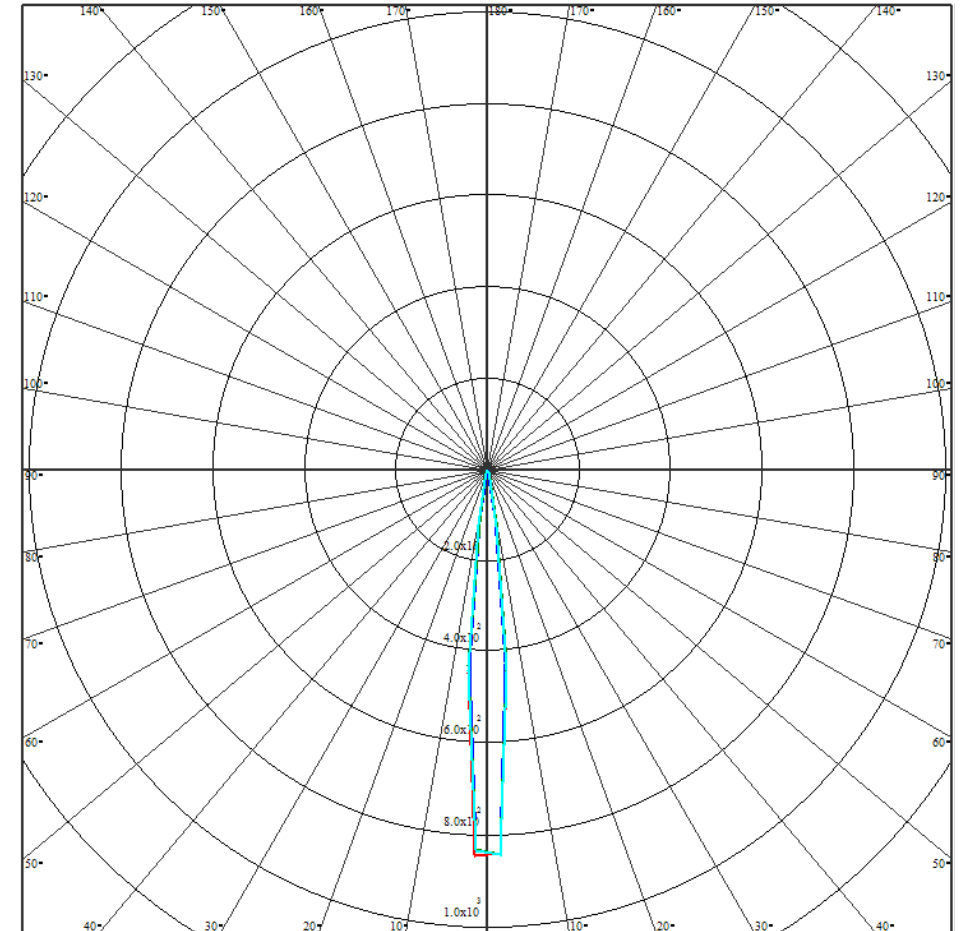

# VEGA45M: Medium beam



## Polar Candela Distribution

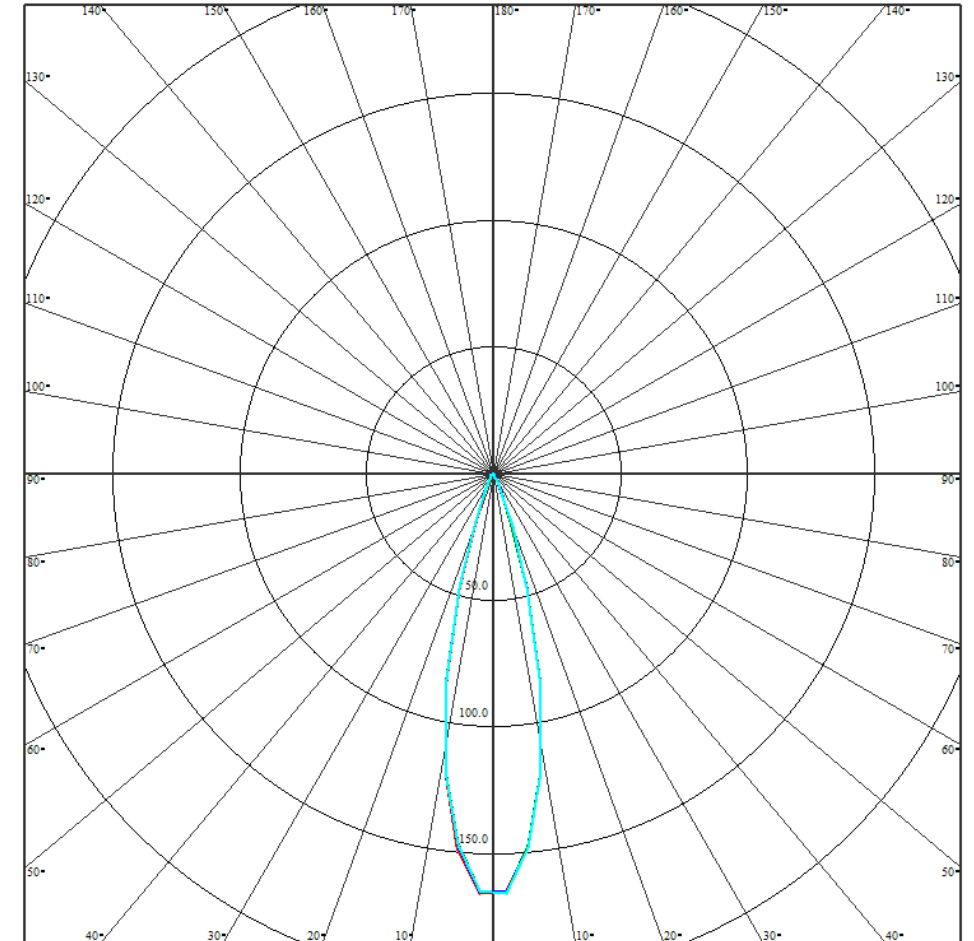

## Compatibility matrix

	CITIZEN	CREE	CREE	BRIDGELUX
VEGA45M	CLU7S3	CXB1310	CXB1520	VESTA_6_TW
FWHM (°)	25,3	25,4	27	25,7
FWTM (°)	43,1	46,2	53,8	46,6
Efficacy (cd/lm)	4	3,4	2,3	3,4

[Visit the product page of the PMMA version](#)

[Visit the product page the PC version](#)

LED: CLU7L3

# VEGA45W: Wide beam



## Polar Candela Distribution

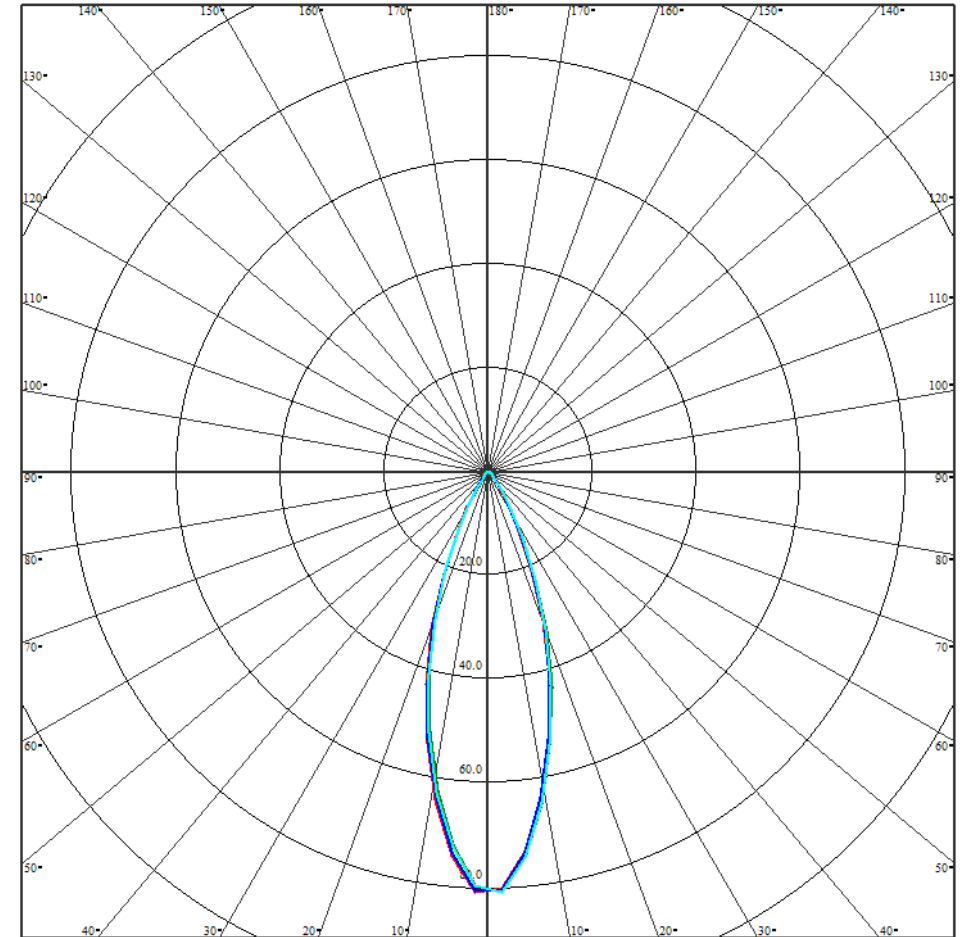

## Compatibility matrix

	CITIZEN	CREE	CREE	BRIDGELUX
VEGA45W	CLU7S3	CXB1310	CXB1520	VESTA_6_TW
FWHM (°)	33,7	34,2	35,2	34,3
FWTM (°)	61,7	63,9	75,1	65,6
Efficacy (cd/lm)	1,9	1,7	1,4	1,7

[Visit the product page of the PMMA version](#)

[Visit the product page the PC version](#)

LED: CLU7L3

# VEGA45E: Elliptical beam



Polar Candela Distribution

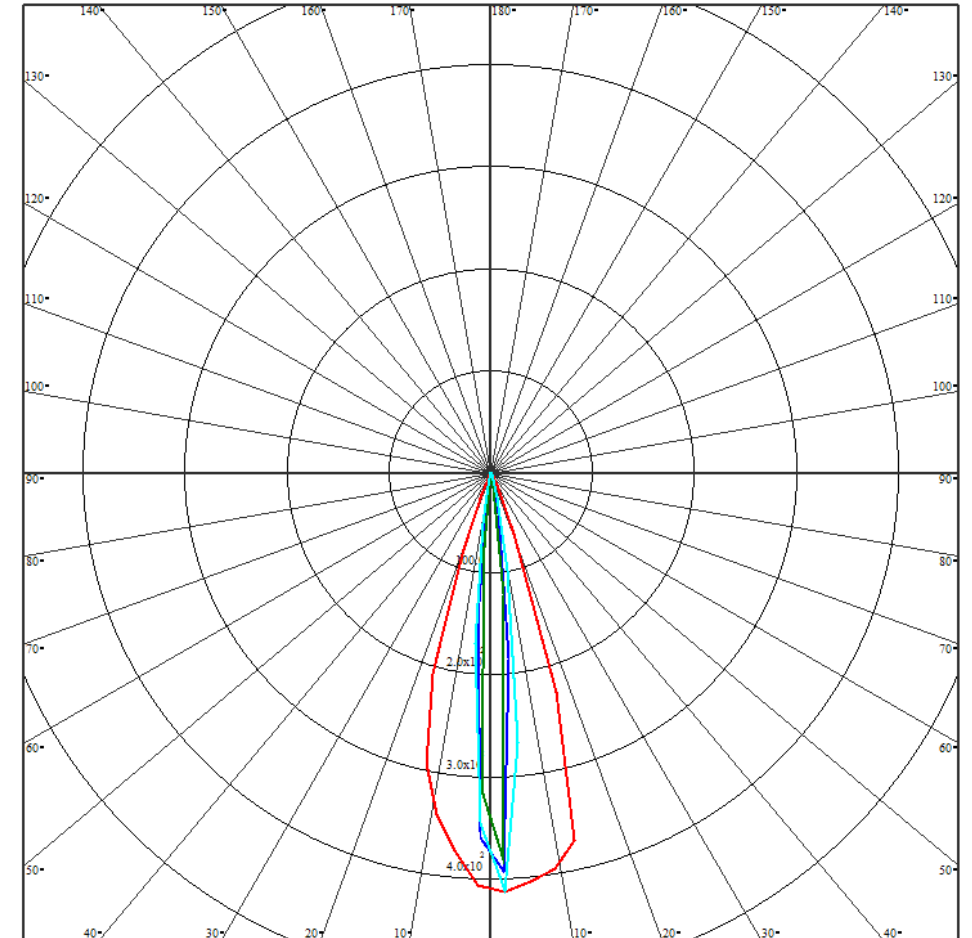

## Compatibility matrix

	CITIZEN	CREE	CREE	BRIDGELUX
LLC59E	CLU7S3	CXB1310	CXB1520	VESTA_6_TW
FWHM (°)	8,8-33,1	14,6-21	17-32,5	13,4-32,4
FTWM (°)	15,7-44,9	26,4-37	33,2-57,8	23,7-51
Efficacy (cd/lm)	8,7	5,5	3,2	5,4

[Visit the product page of the PMMA version](#)

[Visit the product page the PC version](#)

# LLH79Cx

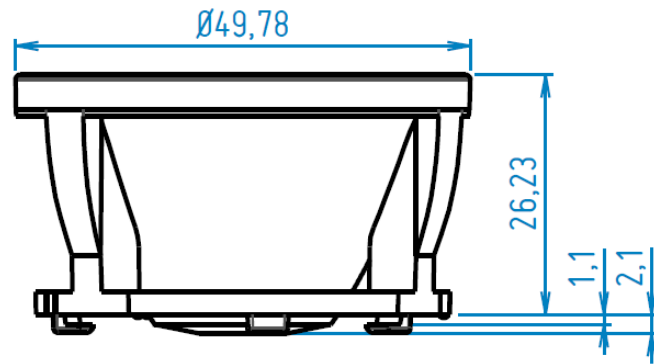

Clear holder

Black holder

Without adhesive: **LLH79C00**

**LLH79C02**

If you need another color of holder, please [contact us](#)

# VEGA: compatible holders

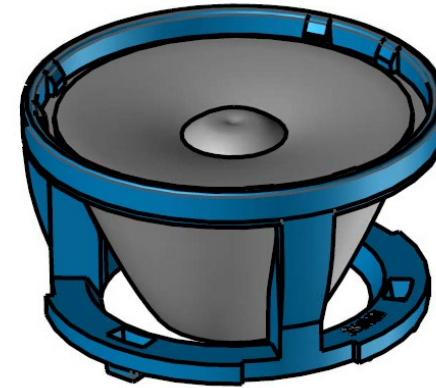

+ [Base LLH66B](#)

LLH66B1**	Bender+Wirth
LLH66B2**	Bridgelux
LLH66B3**	Xicato
LLH66B4**	TE
LLH66B5**	Molex
LLH66B6**	Dedicated to PCB mounted high power LEDs

All dimensions are in millimeters.

General tolerance +/- 0.1mm (standard NF T 58-000 cat. 4, reduced class).

# VEGA: Assembled set

## LLH79C\* + VEGA

HOLDER	Color	Material	VEGA45U	VEGA45UF	VEGA45N	VEGA45C
LLH79C00	Clear (0) Black (2)	PC	SVEGA45U10*	SVEGA45UF10*	SVEGA45N10*	SVEGA45C10*
LLH79C02	Clear (0) Black (2)	PMMA	SVEGA45U0*	SVEGA45UF0*	SVEGA45N0*	SVEGA45C0*

HOLDER	Color	Material	VEGA45M	VEGA45W	VEGA45V	VEGA45E
LLH79C00	Clear (0) Black (2)	PC	SVEGA45M10*	SVEGA45W10*	Coming soon	SVEGA45E10*
LLH79C02	Clear (0) Black (2)	PMMA	SVEGA45M0*	SVEGA45W0*	Coming soon	SVEGA45E0*

\* For the transparent version, add the number 0 at the end of the reference.  
For the black version, add the number 2 to the end of the reference.

# VEGA: Packaging

## VEGAx

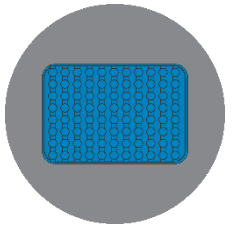

6 thermoformed trays  
with 25 parts each



150 parts  
Box: A13 - 387x283x170 mm  
Weight: 4,8 kg

## SVEGAx

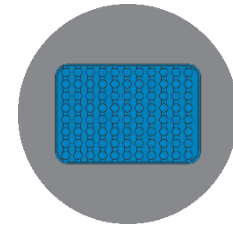

6 plastic plates  
with 35 parts each



210 parts  
Box: A13 - 387x283x170 mm  
Weight: 7,5 kg

# Code form standard range

## LENS

### OPTICAL

01: 16 mm  
02: 16 mm  
12: 16 mm  
22: 16 mm RGBW  
05: 32 mm  
15: 32 mm  
25: 32 mm RGBW  
07: 35 mm  
45: 45 mm UFO or VEGA  
49: 45 mm RGBW  
59: 45 mm RGBW gen 2  
56: 67mm in PMMA  
66: 67 mm in silicone  
76: 67mm in silicone  
67: 67 mm UFO

### PRODUCT

LLC: Collimator  
LLH: Holder  
  
LLL: Linear collimator  
LLR: Reflector  
LLS: Set  
UFO: Ultra Flat Optic  
VEGA : 45mm COB oriented  
AVIKA : Street light solutions  
SIRIUS : Zoom solutions

### BEAM ANGLE

U/R/RF/UF: Ultra Narrow  
N/NF: Narrow  
M: Medium  
W: Wide  
X: Extra large  
S: Super large  
L: Large  
V: Very large  
E: Elliptical  
Z: Zoom

### MATERIAL

0 or nothing : PMMA  
1: PC  
2: PC anti-UV  
7: Silicone

LLS01W01ABC001

**ABC**: Holder type according to LED package

### COLORS & DECORS

0: Translucent  
1: White  
2: Black

### ADHESIVE OPTION

1: Yes  
Nothing: No

### VERSION

### TYPE

1: 16mm  
2: 32mm  
3: 3x16mm  
4: 4x16mm  
9: 45mm

## HOLDER