



# STANDARD RANGE

35 & 50 Zoom Solutions — SIRIUS

February, 2023

# SIRIUS : presentation

ZOOM SOLUTIONS IN  $\varnothing$  35 & 50MM



## SIRIUS35Z

This range is compatible with most brands of COB and High Power LED.



## SIRIUS50Z

The range is compatible with most brands of COB including tunable white COB or cluster of High Power LED.

2 references

# SIRIUS : Kit & set presentation



## KSIRIUS35Z\*

This kit offers different **holders** :

- KSIRIUS35Z1\***: compatible with **Bender+Wirth**
- KSIRIUS35Z4\***: compatible with **TE Connectivity**
- KSIRIUS35Z6\***: compatible with **High Power LED**



## SSIRIUS50Z\*

The set offers **two different windows** :

- SSIRIUS50ZTW\*** : Tunable white window
  - SSIRIUS50Z\*** : Narrower window version
- SSIRIUS50Z\* must be mounted on a LLH66B base to be compatible with B+W, TE, ...

## KIT ≠ SET

**SIRIUS35Z** kit is in spare parts ≠ **SIRIUS50Z** set is assembled

### KSIRIUS35Z\* kit

The kit comes in spare parts with collimator, adjustable window, and holder with innovative rotation stop system.

### SSIRIUS50Z\* assembled set

The assembled set comes with collimator, adjustable window, and holder with innovative rotation stop system.

# SIRIUS: LED specifications

**LES size:** **KSIRIUS35Z\*** : LES up to 10 mm | Optimized for 4-6 mm  
**SSIRIUS50Z\*** : LES up to 13 mm | Optimized for 6-9 mm

**LED type :** High Power, Cluster High Power, Mid Power, Cluster Chip Scale Package, Chip Scale Package (CSP), Chip on Board (COB).

Type of Led	KSIRIUS35Z*	SSIRIUS50ZTW*	SSIRIUS50Z*
RGBW	✗	✗	✗
Tunable White	✓	✓	✗
Single chip	✓	✓	✓
Multi chip	✓	✓	✗
Chip on board	✓	✓	✓
Midpower	✓	✗	✗

# SIRIUS: applications



**INDOOR**



**RETAIL**

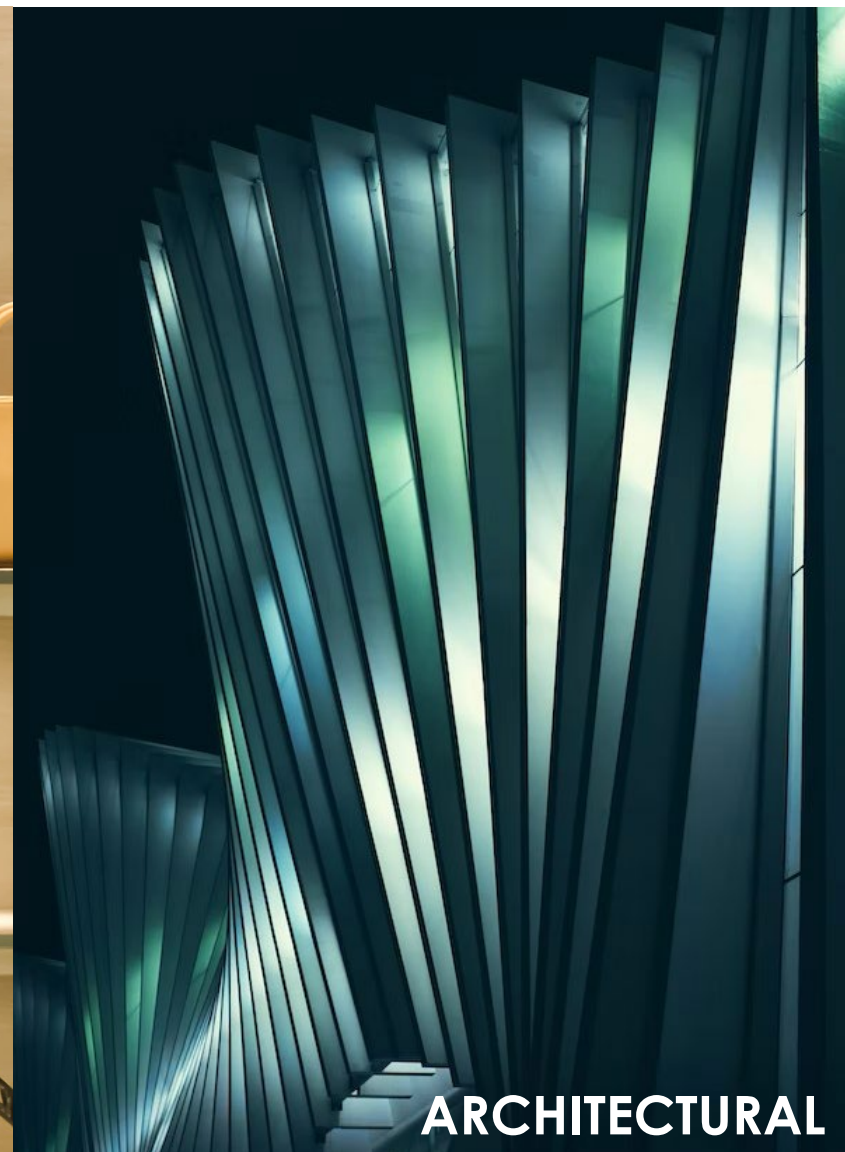

**ARCHITECTURAL**



# SIRIUS - 2D Schematics

All dimensions are in millimeters.

General tolerance +/- 0.1mm (standard NF T 58-000 cat. 4, reduced class).

## SSIRIUS50Z\*

B - B

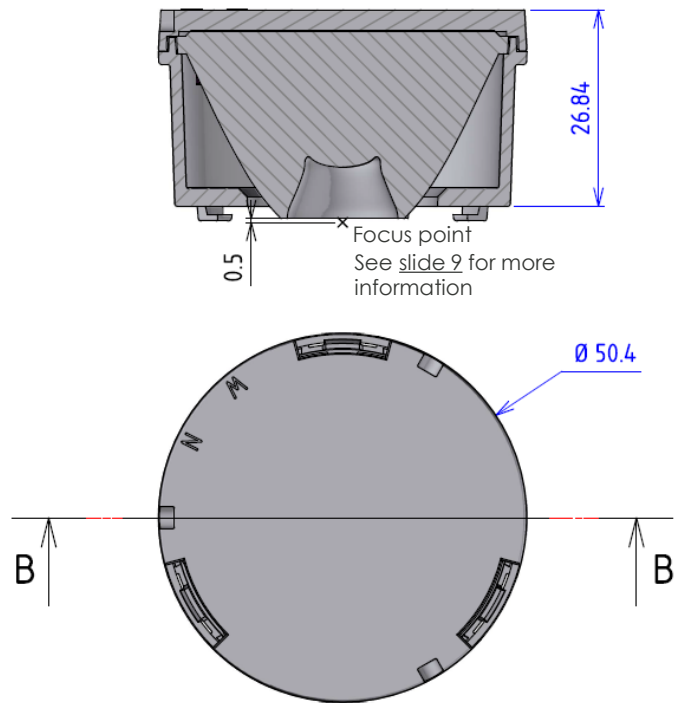

For its assembly, SSIRIUS50Z\* must be mounted on a base. It is compatible with all our [LLH66B\\*](#) bases.

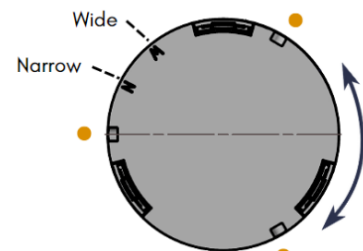

- Rotating window has 3 notches for easy integration to the luminaire

## KSIRIUS35Z\*

KSIRIUS35Z10 / KSIRIUS35Z12  
KIT SIRIUS ZOOM 35 B+W

KSIRIUS35Z40 / KSIRIUS35Z42  
KIT SIRIUS ZOOM 35 TE BJB

KSIRIUS35Z60 / KSIRIUS35Z62  
KIT SIRIUS ZOOM 35 HIGH POWER

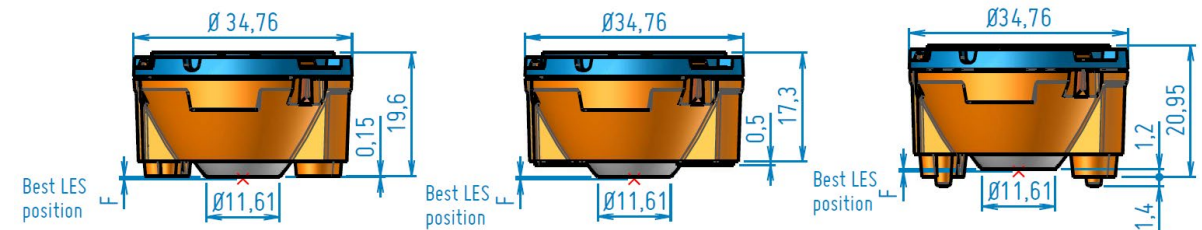

See [slide 9](#) for more information

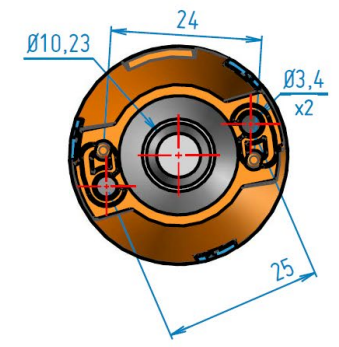
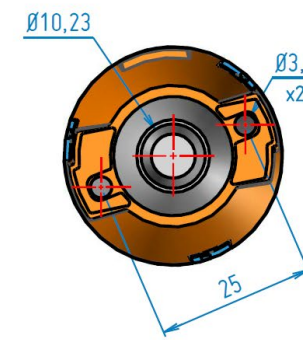
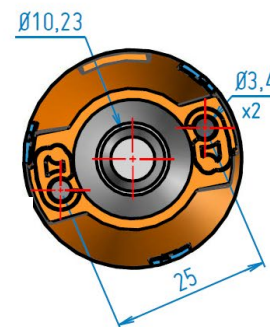

KSIRIUS35Z\* is directly mounted into the COB holder or the PCB with screws (screw holes distance is 25mm).

# KSIRIUS35Z\* - Ø 35mm Zoom



The holder is also available in black

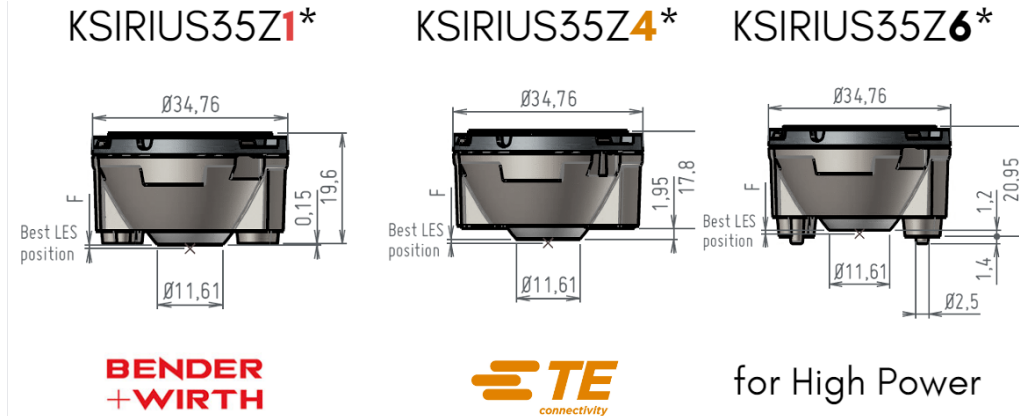

## COMPATIBILITY MATRIX

	LUMINUS	CITIZEN	CREE	CREE
<b>KSIRIUS35Z</b>	<b>CXM_3</b>	<b>CLU702</b>	<b>XHP35.2 HI</b>	<b>XHP50.3 HI</b>
FWHM (°)	16.9 - 47	21.9 - 50.6	15.6 - 47.8	16.7 - 47.6
FWTM (°)	33.9 - 72.8	45.7 - 81.3	30.7 - 72.6	34 - 73.6
Efficacy (cd/lm)	6.8 - 1.4	3.7 - 1.1	7.5 - 1.3	6.4 - 1.3
CCI	0.4	0.8	0.6	1.4

Find more information and ask for samples on each product page :

- KSIRIUS35Z1:** SIRIUS35 kit compatible with **Bender+Wirth** | [KSIRIUS35Z10](#) – for clear holder / [KSIRIUS35Z12](#) – for black holder
- KSIRIUS35Z4:** SIRIUS35 kit compatible with **TE Connectivity** | [KSIRIUS35Z40](#) – for clear holder / [KSIRIUS35Z42](#) – for black holder
- KSIRIUS35Z6:** SIRIUS35 kit compatible with **High Power LED** | [KSIRIUS35Z60](#) – for clear holder / [KSIRIUS35Z62](#) – for black holder

# SSIRIUS50Z\* - Ø 50mm Zoom

## Compatibility matrix



The holder is also available in black

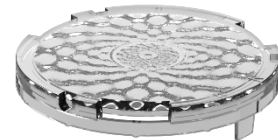

**TW - TUNABLE WHITE**



**NARROWER VERSION**

### SSIRIUS50ZTW\*

	CITIZEN	CREE	LUMILED	CREE
	CLU702	CXB1520	CLUST. TW LUXZ	XHP50B
FWHM (°)	17.8 - 52.2	21.5 - 53	13.5 - 47.4	15.1 - 46.9
FWTM (°)	35.8 - 74.8	43.1 - 78.5	24.9 - 69.4	30.4 - 69.6
Efficacy (cd/lm)	6.6 - 1.2	4.2 - 1.1	15.9 - 1.9	9.3 - 1.5
CCI	0.7	1.1	2.2	0.8

### SSIRIUS50Z\*

	CITIZEN	CREE	BRIDGELUX	CREE
	CLU702	CXB1520	V4 HD BXRH	XHP50B
FWHM (°)	15.3 - 53.1	19 - 53.6	10.3 - 53.1*	10.6 - 48
FWTM (°)	32.4 - 73.9	40.6 - 77.7	20.7 - 72.1*	23 - 67.7
Efficacy (cd/lm)	8.2 - 1.2	5 - 1.1	18.9 - 1.2*	16.5 - 1.6

\*Simulated result

Find more information and ask for samples on each product page :

**SSIRIUS50ZTWO:** SIRIUS50 set with a tunable white window and a clear holder

**SSIRIUS50ZTW2:** SIRIUS50 set with a tunable white window and a black holder

**SSIRIUS50ZO:** SIRIUS50 set with the narrower window and a clear holder

**SSIRIUS50Z2:** SIRIUS50 set with the narrower window and a black holder



# SIRIUS : Best LES position

Achieving an optimal focus position of the lens is the key factor for a successful LED/Collimator integration. The best focus position will be achieved when matching the collimator's focus position with LED's Light Emission Surface position.

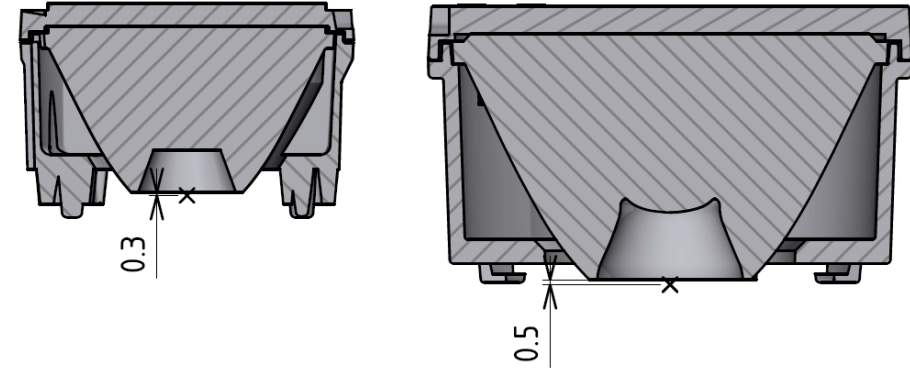

## KSIRIUS35Z\*

This range is directly mounted onto the COB holder or PCB with screws.

SIRIUS35Z focal distance : 0.3mm

## SSIRIUS50Z\*

A base is required to assemble the SSIRIUS50, these zoom solutions are compatible with all our LLH66B\* bases.

SIRIUS50Z focal distance : 0.5mm

### Base references and compatibility

LLH66 base reference	Interface manufacturer	Manufacturer's compatible references
LLH66B10*	<b>BENDER + WIRTH</b>	4xx / Type Z1
LLH66B20*	<b>bridgelux.</b>	Vero10 / Vero13 / Vero18
LLH66B310*	<b>XICATO</b>	XTM / XIM
LLH66B40*	<b>TE</b> connectivity	LUMAWISE Z32 / Z35
LLH66B50*	<b>molex</b> one company a world of innovation	180555-0002
LLH66B60*	Dedicated to PCB mounted high power LEDs	

# SIRIUS: Packaging

## KSIRIUS35Z\*

KSIRIUS35Z\* is a kit, it means you will receive it unassembled.

### WINDOW

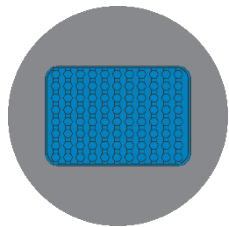

20 trays with  
25 parts each



500 parts  
Box: A15  
30x20x20 mm  
Weight: 2.176kg

### COLLIMATOR

10 trays with  
50 parts each

500 parts  
Box: A13  
387x283x170 mm  
Weight: 5.26kg

### HOLDER

Bulk parts

500 parts  
Box: A15  
30x20x20 mm  
Weight: 1.755kg

## SSIRIUS50Z\*

SSIRIUS50Z\* is a set, it means you will receive it already assembled.

### SET

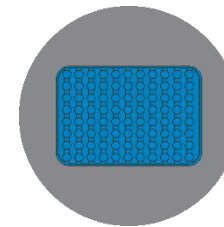

6 thermoformed trays  
with 35 parts each



210 parts  
Box: A13 - 387x283x170 mm  
Weight: 9.39 kg

# Code form standard range

