



STANDARD RANGE

Street lighting solutions

AVIKA2X25050 and AVIKA8X1

March, 2024

NEW



ø50 mm
(for up to 5050)

AVIKA2X25050

- Industry's standard AVIKA-2X2 lenses optimized for Illuminance and Luminance based roads with low threshold increment requirements.
- Optics are optimized for EN13201 M roads, providing excellent uniformity with minimized backlight
- First optics in the market passing requirements with both 5050 and 3535 LED packages
- Screw mounting from the middle
- >90% Optical efficiency
- Black mask available to minimize backlight in regulated areas for even better backlight control
- AVIKA is available for following IESNA classes
 - TYPE I MEDIUM (LN1)
 - TYPE II SHORT
 - TYPE II MEDIUM (ME)
 - TYPE III SHORT
 - TYPE III MEDIUM (LW1)

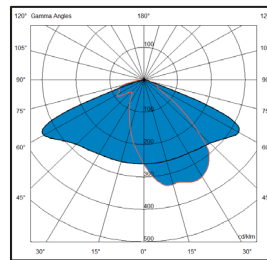
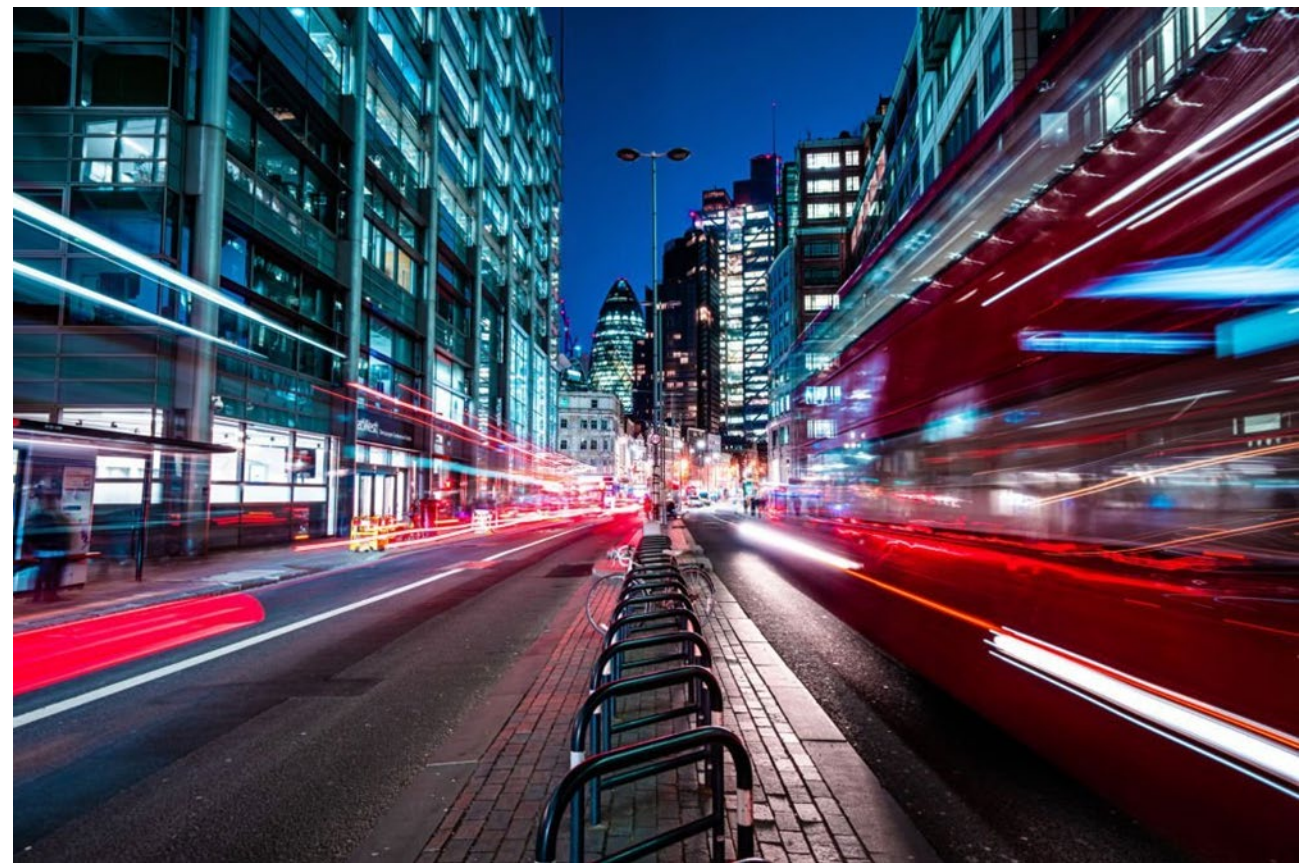

T2S

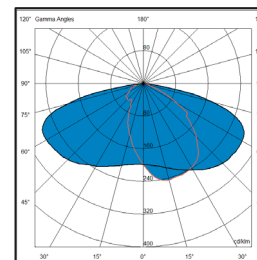

T3S

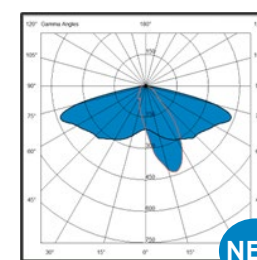

LN1

NEW

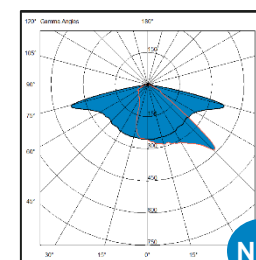

ME

NEW

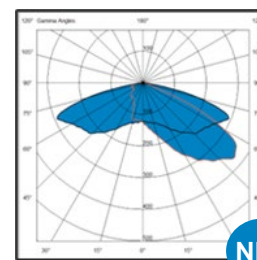

LW1

NEW



** Photometries with protective glass

NEW



ø50 mm
(for up to 5050)

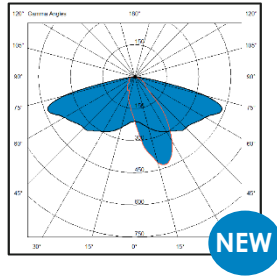

AVIKA2X25050LN1

Regulation M3 road, motorway. IESNA TYPE I M

- 1. **Luminaires on the side:** (2 lanes, two way),
 - LED Type: 5050 & 3535
 - **Average Road Brightness** : >1.0cd/m²(min)
 - **Width per lane** : **7m** (3.5m x 2)
 - Pole distance : **46 m**
 - Pole Height : **10 m**
 - Boom length : **1 meter**
 - Boom Angle : 0
 - Maintenance factor : 0.80
 - Overhang : 0 m
 - Pole distance to roadway: 0
 - Overall uniformity : U0: 0.45
 - Traffic lane uniformity : U1: 0.65
 - Edge illumination ratio : EIR: 0.3
 - Glare : TI: 11
 - Lumens : **14 000lm**
 - Road condition : **Tarmac (R3)**
- Luminous intensity class: CUTOFF



Confidential

NEW



ø50 mm
(for up to 5050)

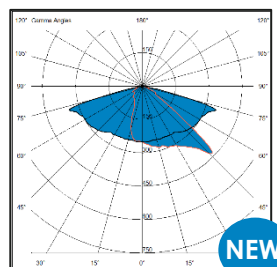

AVIKA2X25050ME

Regulation M3 road, motorway. IESNA TYPE II M

- 1. **Luminaires on the side:** (3 lanes, one way),
 - LED Type: 5050 & 3535
 - **Average Road Brightness** : >1.0cd/m²(min)
 - Width per lane : 10.5m (3.5m x 3)
 - Pole distance : **45 m**
 - Pole Height : **10 m**
 - Boom length : **1 meter**
 - Boom Angle : 0
 - Maintenance factor : 0.80
 - Overhang : -0.650 m
 - Pole distance to roadway: 0
 - Overall uniformity : U0: 0.55
 - Traffic lane uniformity : UI: 0.70
 - Edge illumination ratio : EIR: 0.7
 - Glare : TI 13
 - Lumens : 19 000
 - Road condition : **Tarmac (R3)**
- Luminous intensity class: CUTOFF



Confidential

NEW



ø50 mm
(for up to 5050)

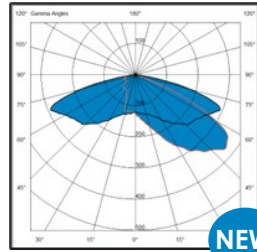

AVIKA2X25050LW1

Regulation M3, roads with multiple lanes. Type-3 Medium.

Luminaires on the side: 1 Luminaire (4 lanes, two way),

- LED Type: 5050 & 3535
 - **Average Road Brightness** : >1.0cd/m²(min)
 - Width per lane : 15m (3.75m x 4)
 - Pole distance : **56 m**
 - Pole Height : **12 m**
 - Boom length : **1 m**
 - Boom Angle : 0-5
 - Maintenance factor : 0.80
 - Overhang : -2 m
 - Pole distance to roadway: 3
 - Overall uniformity : U0: 0.4min < **target 0.50**
 - Traffic lane uniformity : U1: 0.7min < **target 0.70**
 - Edge illumination ratio : EIR: 0.3min
 - Glare : TI=<11min
 - Lumens : **31 500lm**
 - Road condition : **Tarmac (R3)**
- Target Luminous intensity class: CUTOFF or FULL CUTOFF



Confidential

NEW

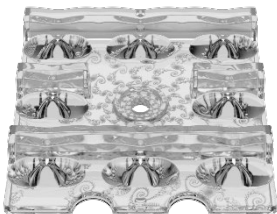

ø50 mm
(for up to 3535)

AVIKA8X1

- Industry's standard AVIKA-8X1 lenses optimized for Illuminance and Luminance based roads
- Optimized for High Power 3535 packages
- Excellent uniformity with minimized backlight and best lm/\$
- Screw mounting from the middle
- >90% Optical efficiency
- Black mask available to block backlight
- AVIKA is available for following IESNA classes
- TYPE I MEDIUM
- TYPE II MEDIUM
- TYPE III MEDIUM

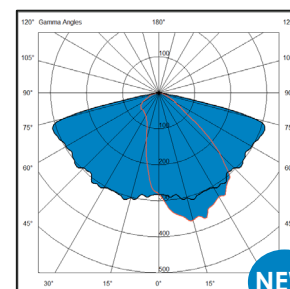

T1M

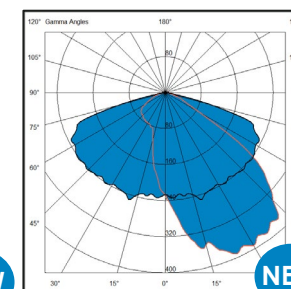

T2M

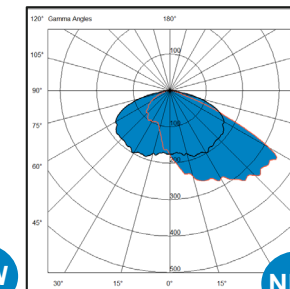

T3M



Confidential

** Photometries with protective glass

AVIKA: Mask Compatibilities

Optical component : AVIKA* + Mask : AVIKA*M

Optical component	Mask
AVIKA 2x2 5050 T3S	AVIKA 2x2 5050 T3S M
AVIKA 2x2 5050 T2S	AVIKA 2x2 5050 T2S M
AVIKA 2x2 5050 T3M	AVIKA 2x2 5050 T3M M
AVIKA 2x2 5050 LN1	M1 AVIKA 2X2 5050
AVIKA 2x2 5050 ME	M1 AVIKA 2X2 5050
AVIKA 2x2 5050 LW1	M1 AVIKA 2X2 5050
AVIKA 8X1 T1M	M1 AVIKA 8X1
AVIKA 8X1 T2M	M1 AVIKA 8X1
AVIKA 8X1 T3M	M1 AVIKA 8X1

AVIKA: 2D drawing

All dimensions are in millimeters.
standard NF T 58-000 cat. 4, reduced class.

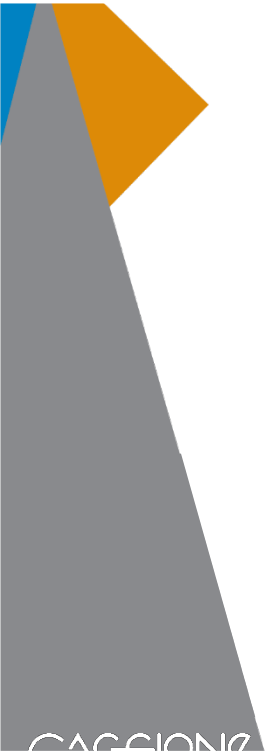
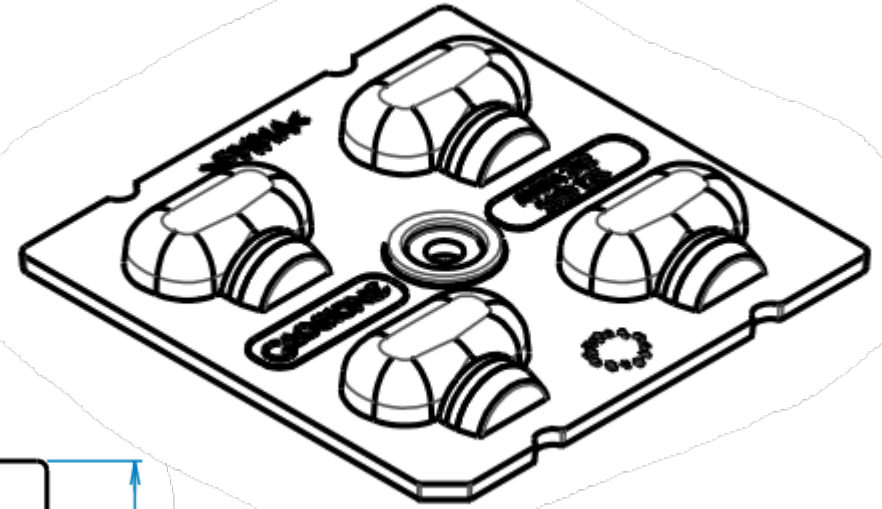
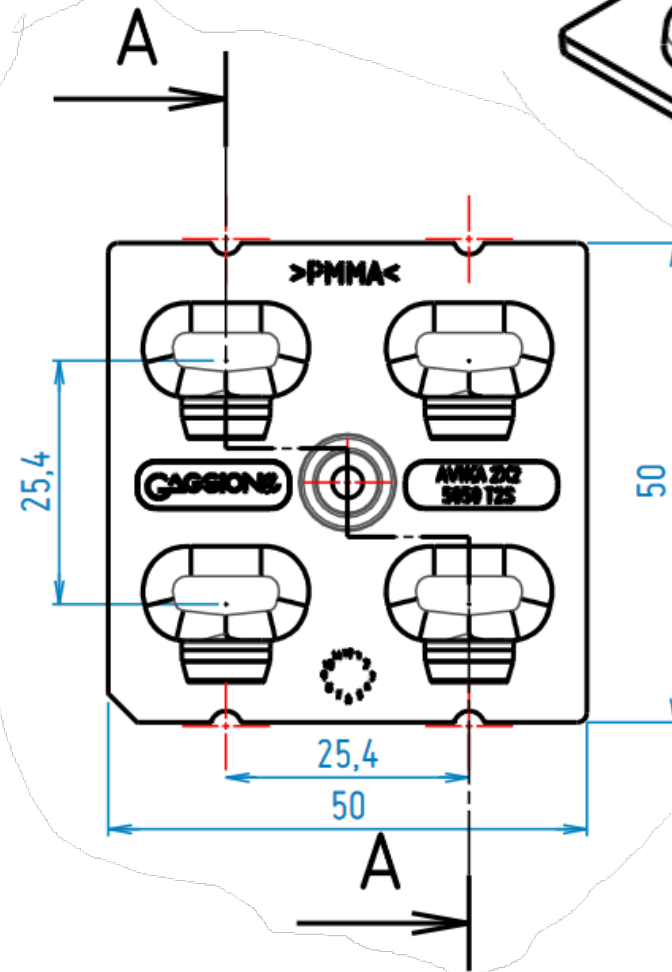
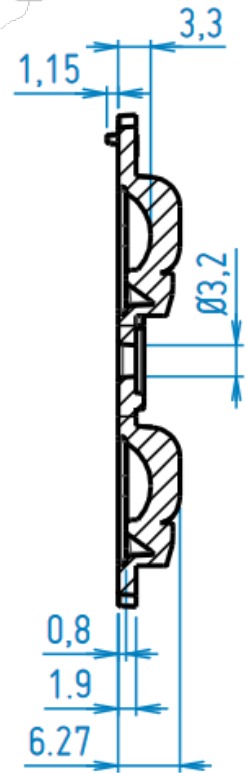
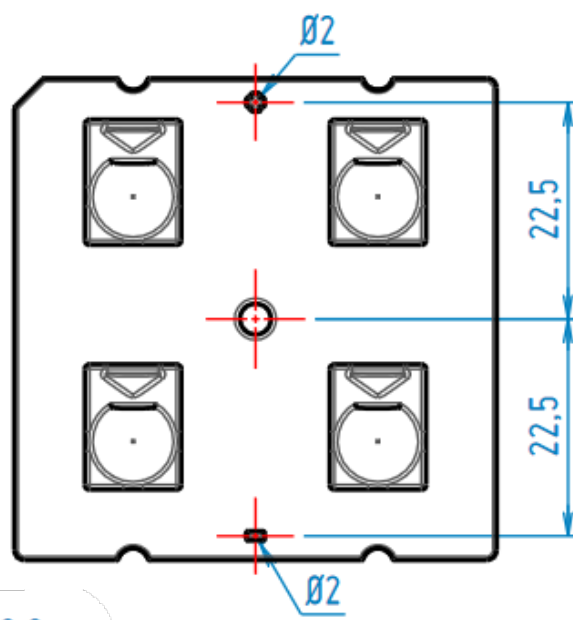

AVIKA: Packaging

AVIKA2X25050

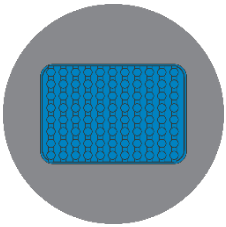

4 layers of 165 pieces
individually packed



660 parts
Box: 340x320x260mm
Weight: 6 kg

AVIKA8X1

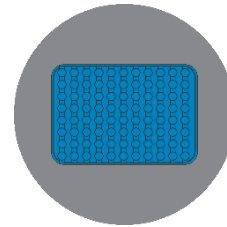

4 layers of 153 pieces
individually packed



612 parts
Box: 340x320x260mm
Weight: 6 kg

Code form standard range

LENS

OPTICAL

- 01: 16 mm
- 02: 16 mm
- 12: 16 mm
- 22: 16 mm RGBW
- 05: 32 mm
- 15: 32 mm
- 25: 32 mm RGBW
- 07: 35 mm
- 45: 45 mm UFO or VEGA
- 49: 45 mm RGBW
- 59: 45 mm RGBW gen 2
- 56: 67mm in PMMA
- 66: 67 mm in silicone
- 76: 67mm in silicone
- 67: 67 mm UFO

PRODUCT

- LLC: Collimator
- LLH: Holder
- LLL: Linear collimator
- LLR: Reflector
- LLS: Set
- UFO: Ultra Flat Optic
- VEGA : 45mm COB oriented
- AVIKA : Street Lighting

BEAM ANGLE

- U/R/RF/UF: Ultra Narrow
- N/NF: Narrow
- M: Medium
- W: Wide
- X: Extra large
- S: Super large
- L: Large
- V: Very large
- E: Elliptical
- Z: Zoom

MATERIAL

- 0 or nothing : PMMA
- 1: PC
- 2: PC anti-UV
- 7: Silicone

LLS01W01ABC001

ABC: Holder type according to LED package

COLORS & DECORS

- 0: Translucent
- 1: White
- 2: Black

ADHESIVE OPTION

- 1: Yes
- Nothing: No

VERSION

TYPE

- 1: 16mm
- 2: 32mm
- 3: 3x16mm
- 4: 4x16mm
- 9: 45mm

HOLDER

Contact us

GAGGIONE SAS Headquarter

3, Rue de la Rolland
01460 Montréal la Cluse
France

☎ +33 4 74 76 12 66
@ contact@gaggione.com
🌐 www.optic-gaggione.com

Sales Team in GAGGIONE

Sandrine Mancuso
France, UK, Italy, Spain

@ s.mancuso@gaggione.com
☎ +33 787 87 84 72

Nicolas Golfier
France, Scandinavia,
Eastern and Northern Europe

@ n.golfier@gaggione.com
☎ +33 677 35 50 37

Laurent Barel
Sales & Marketing Director

@ l.barel@gaggione.com
☎ +33 612 04 41 30

International Sales Offices

GAGGIONE Americas
Michael Pietro
12833 Surrey Ct.
Palos Park, IL
60464

@ m.pietro@gaggione.com
☎ +1 224 392 0087

GAGGIONE Asia
Zhen Xu
Unit 1808, No. 8, Kuaiji Road,
Jintiandi International building,
Huangpu District,
Shanghai, 200021, China

@ z.xu@gaggione.com
☎ +86 136 5189 6981

GAGGIONE Canada
Stephane Saindon
744 36th Avenue
Montreal, Quebec
H8T3L2

@ s.saindon@gaggione.com
☎ +1 514 928 2179

GAGGIONE DACH
Angelika Aigner
Kreuzstrasse 7
83355 Grabenstätt
Germany

@ a.aigner@gaggione.com
☎ +49 8661 983 44 77

Product Management & Business development

Joni MÄKI
Artunkuja 7,
24260 Salo
FINLAND

@ j.maki@gaggione.com
☎ +33 6 38 24 17 51