

Gehäusetyp: Housing:	<b>Bayonet35</b>	Größe / Size : 32mm Höhe / Height : 5,3 / 3,6 mm
-------------------------	------------------	---

Beispiele für passende Optiken examples of suitable optics	<b>GAGGIONE HADAR70H40* (-ZOOM)</b>
---	-------------------------------------

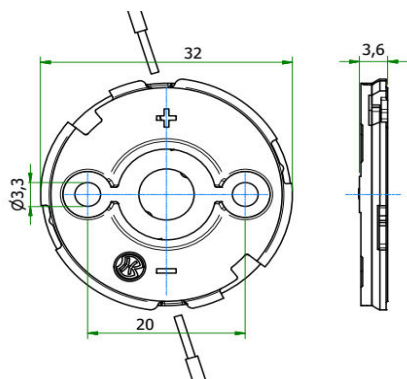

Version 1 Bayonet35/20 : 634x, 652x, 660x, 667x



Spezielle Schraube mit flachem Kopf erforderlich  
 Special flat head screw required

e.g. 48279  
 M3 x 8mm

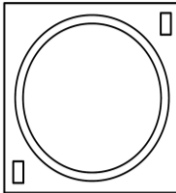

<p><b>Bemessungsspannung</b> rated voltage</p> <p><b>Bemessungsstrom</b> rated current</p> <p><b>Bemessungstemperatur</b> rated operating temperature</p> <p><b>Befestigung</b> fixing</p> <p><b>max. Drehmoment</b> max. torque</p> <p><b>Material des Halters</b> material of the holder</p> <p><b>Kontaktmaterial</b> contactmaterial</p>	<p>Standard 250V DC optional 450V DC</p> <p>5 A</p> <p>T 120</p> <p>2 Schrauben M3 2 screws M3</p> <p>0,3 Nm</p> <p>PBT / Mikanit PBT / Mica</p> <p>CuSn CuSn</p>	<p><b>Zulässige COB Abmessungen</b> Permissible COB dimensions</p> <div style="display: flex; align-items: center;">  <p>siehe Einzeldatenblätter im Online Katalog see data sheets at our web catalogue</p> </div> <p style="text-align: center;"><b>Zertifikate / certificates</b></p> <div style="display: flex; align-items: center;">  <p>Ausweis-Nr.</p>  <p>File E4729</p> </div>
--	---	---

Weitere technische Daten und Montagehinweise sind im [Technical Guide COB Halterserie 630](#) enthalten.  
 Further technical details and mounting instructions are part of the [Technical Guide COB holder series 630](#).

Teilumhüllter Halter für folgende COBs / unenclosed holder for the following COBs:				
Hersteller supplier	COB Typ COB Type	Teile-Nr. part no.	Haltervariante variant of holder	
Bridgelux	V3 HD / V4 HD Gen 7,8	<b>49692</b>	COB Holder Hybrid 660a	Bayonet35/20
Bridgelux	V6 HD Gen 7,8	<b>49046</b>	COB Holder Hybrid 634c	Bayonet35/20
Bridgelux	V6 Gen 8,9 (just 2 pads!)	<b>49692</b>	COB Holder Hybrid 660a	Bayonet35/20
Bridgelux	V8 Gen 7,8,9 (4 pads)	<b>49692</b>	COB Holder Hybrid 660a	Bayonet35/20
Bridgelux	V10 Gen 7,8,9	<b>49047</b>	COB Holder Hybrid 634b	Bayonet35/20
Bridgelux	Vesta DTW 6/9mm Gen 1,2	<b>49040</b>	COB Holder Hybrid 652b	Bayonet35/20
Citizen	CLU 028 / 02J / 02Q	<b>49039</b>	COB Holder Hybrid 634a	Bayonet35/20
Citizen	CLU 7L3 / 7S3	<b>49355</b>	COB Holder Hybrid 667a	Bayonet35/20
Citizen	CLU 702 / 703 / 7A2 / 7A3 / 7B2	<b>49039</b>	COB Holder Hybrid 634a	Bayonet35/20
CREE	CHA 0304 / 0410 / 0612	<b>49039</b>	COB Holder Hybrid 634a	Bayonet35/20
CREE	CMA 1303 / 1306	<b>49046</b>	COB Holder Hybrid 634c	Bayonet35/20
CREE	CMB 1304 / 1306	<b>49046</b>	COB Holder Hybrid 634c	Bayonet35/20
CREE	CMT 1407 / 1412 / 1420	<b>49039</b>	COB Holder Hybrid 634a	Bayonet35/20
CREE	CMU 1003 / 1006 / 1010 / 1013	<b>49039</b>	COB Holder Hybrid 634a	Bayonet35/20
CREE	CXB 1304 / 1310	<b>49046</b>	COB Holder Hybrid 634c	Bayonet35/20
Edison	2PHE 03 / 06 / 09 / 13	<b>49039</b>	COB Holder Hybrid 634a	Bayonet35/20
Lextar	PB 06 / 09 / 13	<b>49039</b>	COB Holder Hybrid 634a	Bayonet35/20
Lumileds	Luxeon 1202s / 1202HD	<b>49049</b>	COB Holder Hybrid 652a	Bayonet35/20
Lumileds	CS COB L02 / L04	<b>49039</b>	COB Holder Hybrid 634a	Bayonet35/20
Lumileds	CX Plus HD S01H4, S0xH6	<b>49046</b>	COB Holder Hybrid 634c	Bayonet35/20
Lumileds	CX Plus HD S04H9	<b>49047</b>	COB Holder Hybrid 634b	Bayonet35/20
Lumileds	CX Plus S01Fx / S02Fx	<b>49046</b>	COB Holder Hybrid 634c	Bayonet35/20
Luminus	CXM-3-xC	<b>49039</b>	COB Holder Hybrid 634a	Bayonet35/20
Luminus	CHM-4-BH / CXM-4-xC	<b>49039</b>	COB Holder Hybrid 634a	Bayonet35/20
Luminus	CHM-6-BH / CXM-6-xC	<b>49039</b>	COB Holder Hybrid 634a	Bayonet35/20
Luminus	CIM/CLM/CXM-9-xC	<b>49039</b>	COB Holder Hybrid 634a	Bayonet35/20
Luminus	CDM-6 / CDM-9Gen1 DtW	<b>49040</b>	COB Holder Hybrid 652b	Bayonet35/20
Luxtech	COB-WD-10-1512	<b>49049</b>	COB Holder Hybrid 652a	Bayonet35/20
Nichia	NV..S007Z / NF..T012B	<b>49049</b>	COB Holder Hybrid 652a	Bayonet35/20
Nichia	NF..S024B / NT..S024B	<b>49049</b>	COB Holder Hybrid 652a	Bayonet35/20
Nichia	NJ..S024Z	<b>49049</b>	COB Holder Hybrid 652a	Bayonet35/20
Philips	Fortimo SLM12xx .. 1215 G7	<b>49049</b>	COB Holder Hybrid 652a	Bayonet35/20
Philips	Fortimo SLM12xx .. 1313 G7N	<b>49039</b>	COB Holder Hybrid 634a	Bayonet35/20
Prolight Opto	PASB	<b>49039</b>	COB Holder Hybrid 634a	Bayonet35/20
Prolight Opto	PASQ/PAPQ DimToWarm	<b>49039</b>	COB Holder Hybrid 634a	Bayonet35/20
Prolight Opto	PDSQ DimToWarm	<b>49040</b>	COB Holder Hybrid 652b	Bayonet35/20
Samsung	LC 010C	<b>49039</b>	COB Holder Hybrid 634a	Bayonet35/20
Samsung	LC 003D / 006D	<b>49039</b>	COB Holder Hybrid 634a	Bayonet35/20
Samsung	LC 009D / 013D	<b>49039</b>	COB Holder Hybrid 634a	Bayonet35/20
Seoul	SAW* 0661	<b>49047</b>	COB Holder Hybrid 634b	Bayonet35/20

**COB HALTER HYBRID**  
**COB HOLDER HYBRID**

**630**



Seoul	SAW* 1062 / 1063	<b>49047</b>	COB Holder Hybrid 634b	Bayonet35/20
Tridonic	SLE ADV8 LES 04 / 06	<b>49039</b>	COB Holder Hybrid 634a	Bayonet35/20
Tridonic	SLE ADV8 LES 09	<b>49039</b>	COB Holder Hybrid 634a	Bayonet35/20
Tridonic	SLE SNC8 LES 06	<b>49039</b>	COB Holder Hybrid 634a	Bayonet35/20
Tridonic	SLE SNC8 LES 09	<b>49039</b>	COB Holder Hybrid 634a	Bayonet35/20
VS Lighting	DMS 102 ***W	<b>49039</b>	COB Holder Hybrid 634a	Bayonet35/20
VS Lighting	DMS 124 ***W	<b>49039</b>	COB Holder Hybrid 634a	Bayonet35/20
VS Lighting	VCA 042	<b>49047</b>	COB Holder Hybrid 634b	Bayonet35/20
VS Lighting	VCA2 122 / 123 / 124	<b>49047</b>	COB Holder Hybrid 634b	Bayonet35/20
VS Lighting	WU-M-618 DimToWarm	<b>49039</b>	COB Holder Hybrid 634a	Bayonet35/20
Xicato	XOB 04	<b>49047</b>	COB Holder Hybrid 634b	Bayonet35/20
Xicato	XOB 06 (B)	<b>49047</b>	COB Holder Hybrid 634b	Bayonet35/20
Xicato	XOB 09	<b>49039</b>	COB Holder Hybrid 634a	Bayonet35/20

**Wir helfen Ihnen gerne weiter.  
Sprechen Sie uns einfach an!**

Please don't hesitate to contact us  
for any further questions.

**BENDER  
+ WIRTH**



**Ihr Kontakt:**  
Your contact:

**Michael Kritzler**  
Head of Engineering  
+49 (0) 2359 / 669 - 184  
kritzler@bender-wirth.de

**Bender + Wirth GmbH & Co.**  
D-58566 Kierspe, Germany  
+49 (2359) / 669 - 0  
sales@bender-wirth.de  
www.bender-wirth.de